

Arboricultural Impact Assessment for Sandy Bay, Porthcawl

*Inspected by:-
Julian Wilkes BSc.For, MSc.Land Man, MIC.For, TechArb
Treescene Ltd
The Walled Garden
Old Coedarhydyglyn
St Nicholas
Cardiff
CF5 6SG
Tel No. 029 20599300*

17th November, 2025

**Registered Office: Treescene Limited
The Walled Garden, Old Coedarhydyglyn, St. Nicholas, Cardiff CF5 6SG
Tel. 029 205 99300 Email. trees@treescene.co.uk**

1. BRIEF

I have been instructed by Mr. Liam Hopkins of The Urbanists to prepare an Arboricultural Impact Assessment (AIA) in relation to a proposed development at Sandy Bay, Porthcawl.

2. TREE SURVEY AND PLAN

The information within this document is based on the Treescene Tree Survey dated 22/09/2025 and the Treescene AIA Plan 11/2025.

3. TREES TO BE REMOVED

a. Arboricultural Reasons

Trees T6, G9, T26, T32, T33, T37, T39 and T58 are recommended for removal in the Tree Survey due to poor quality (U category). Some of these are trees infected with Ash Dieback Disease (*Hymenoscyphus fraxineus*).

b. To Facilitate Development

Trees G14, T15, G16, T17, T18, G21 (part- southern sections), T22, T23, G24, G25, G27, T28, T29, G30, G31 (part- southernmost specimen), T34, G35, T36, G38 and G40 (part-southern section) are proposed for removal to accommodate the development layout.

These are all C category trees (low quality) except G21, T23, G27, T36, G38 and G40 (B category, moderate quality).

Trees to be removed are indicated on the attached Treescene AIA Plan 11/2025.

4. TREE PRUNING

Some of the trees to be retained contain structural defects/deadwood or may impede vehicle/pedestrian movements within the site. Works to improve tree safety or remove a potential source of nuisance are detailed in the Preliminary Management Recommendations within the Tree Survey. All pruning and felling/coppicing works are to be undertaken by suitably qualified and experienced Arboricultural Contractors working to BS3998:2010 Recommendations for Tree Work.

5. ROOT PROTECTION AREA (RPA) INCURSIONS

There are no conflicts between proposed structures and RPAs of trees to be retained apart from in the following circumstances;

G19- road on eastern fringe of RPA impacts on less than 2% of total RPA.

G21- various footpaths located within RPAs.

In all circumstances the incursions are slight (generally less than 5% of the total RPA affected) and therefore there will be minimal adverse impact upon the future health of the affected trees. However, in order to ensure that the affected trees are not damaged as a result of the development special excavation and construction techniques, to be detailed in a site-specific Arboricultural Method Statement (AMS), could be employed in these areas.

6. PROTECTION OF RETAINED TREES

All trees to be retained should be protected by fencing in accordance with the details in BS5837:2012. The implementation of the tree protection on site should be in compliance with a site-specific Tree Protection Plan (TPP) and Arboricultural Method Statement (AMS).

7. IMPACT ON LOCAL AMENITY

Tree loss in relation to the development focuses primarily on the clearance of mainly lower quality trees in the interior of the site to create space for site access/internal roads as well as to create space to install various housing plots. Some existing tree belts/groups, particularly on the northern boundary of the site as well as most of the central internal block of woodland are retained thus minimising any wider landscape impacts.

Extensive new tree planting within the site is proposed thus mitigating any tree loss and contributing to an enhancement of the local tree stock as a result of the proposed development.

Sandy Bay, Porthcawl

Arboricultural Impact Assessment

Arboricultural Impact Assessment

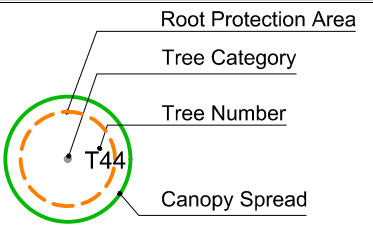

- Trees to be Removed for Arboricultural Reasons
- Trees to be Removed for Development Reasons
- Category A Trees to be Retained
- Category B Trees to be Retained
- Category C Trees to be Retained

Scale 1:4500 @A3
11/2025

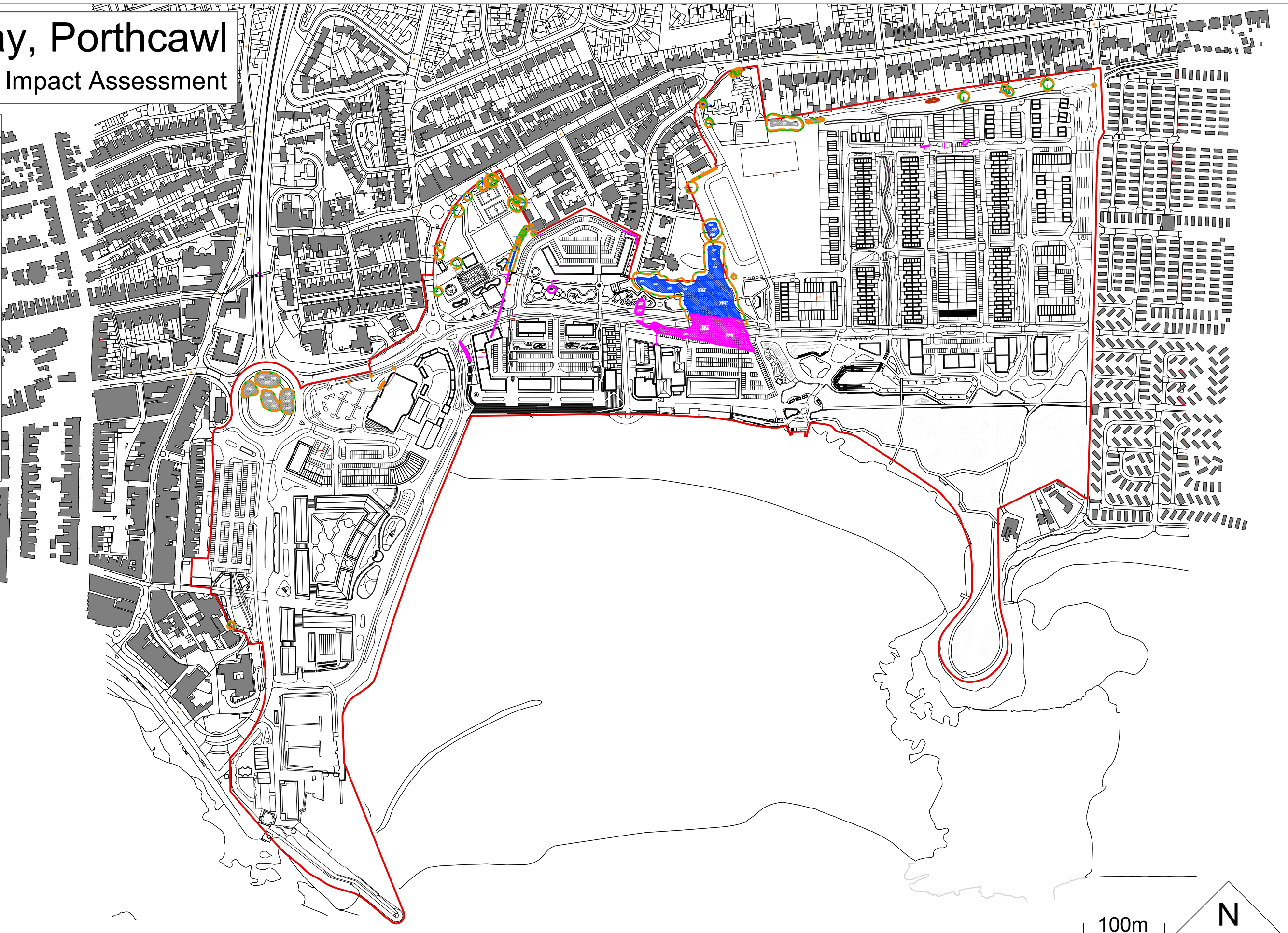

100m



Sandy Bay, Porthcawl

Arboricultural Impact Assessment

Arboricultural Impact Assessment

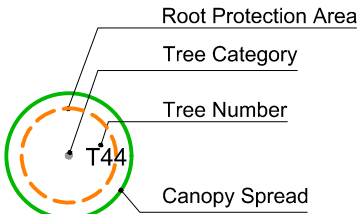

- Trees to be Removed for Arboricultural Reasons
- Trees to be Removed for Development Reasons
- Category A Trees to be Retained
- Category B Trees to be Retained
- Category C Trees to be Retained

Scale 1: 400 @A3
11/2025

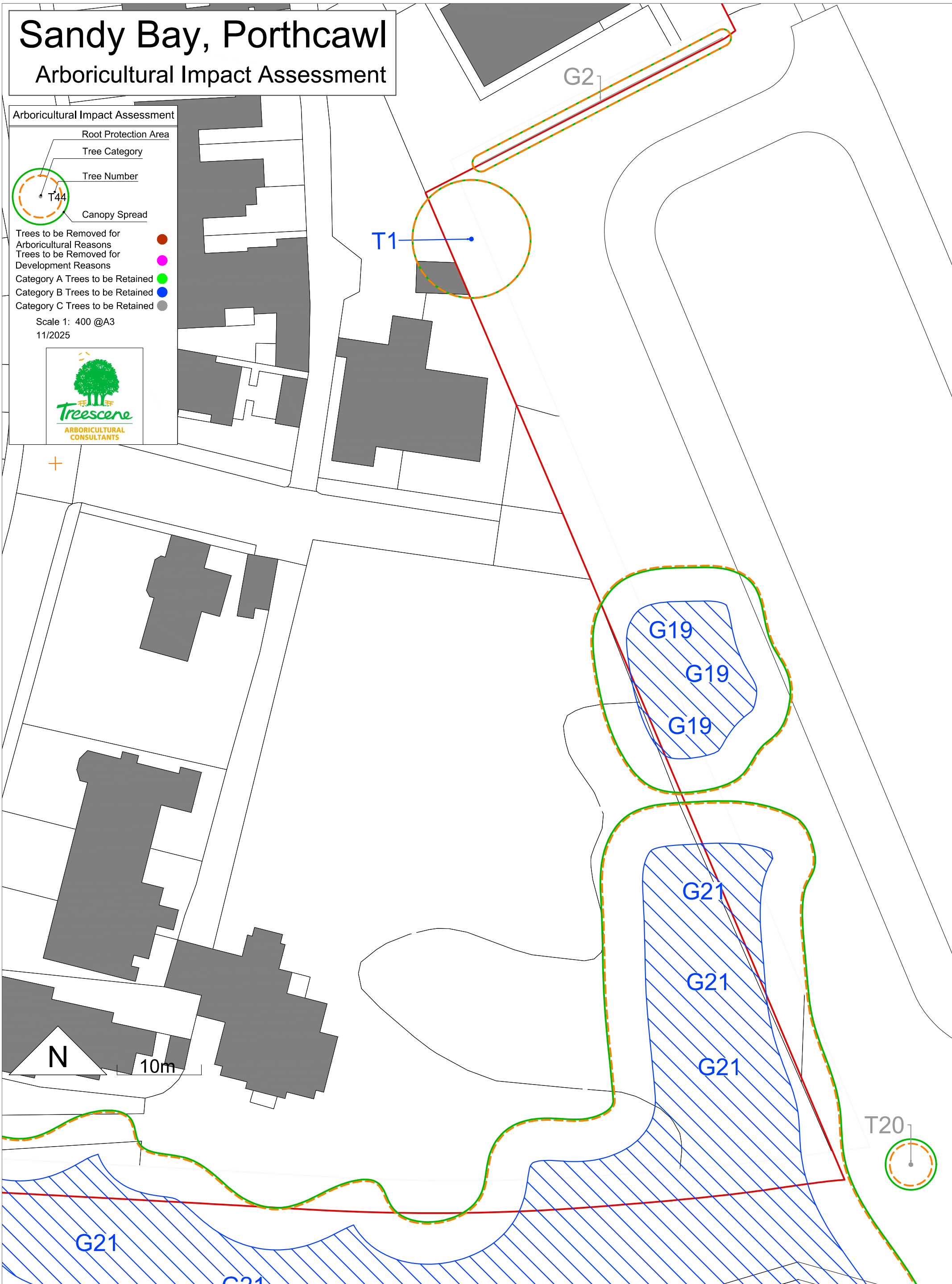

Sandy Bay, Porthcawl

Arboricultural Impact Assessment

Arboricultural Impact Assessment

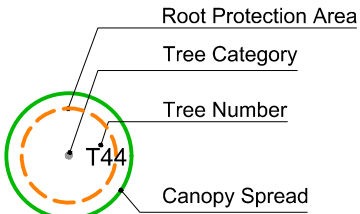

- Trees to be Removed for Arboricultural Reasons
- Trees to be Removed for Development Reasons
- Category A Trees to be Retained
- Category B Trees to be Retained
- Category C Trees to be Retained

Scale 1: 400 @A3

11/2025

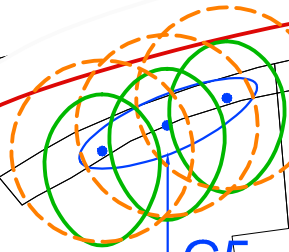
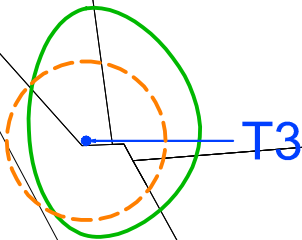
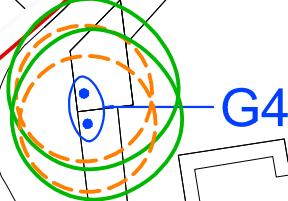

G2

N

10m

Sandy Bay, Porthcawl

Arboricultural Impact Assessment

Arboricultural Impact Assessment

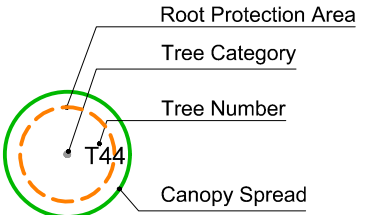

- Trees to be Removed for Arboricultural Reasons
- Trees to be Removed for Development Reasons
- Category A Trees to be Retained
- Category B Trees to be Retained
- Category C Trees to be Retained

Scale 1: 400 @A3
11/2025

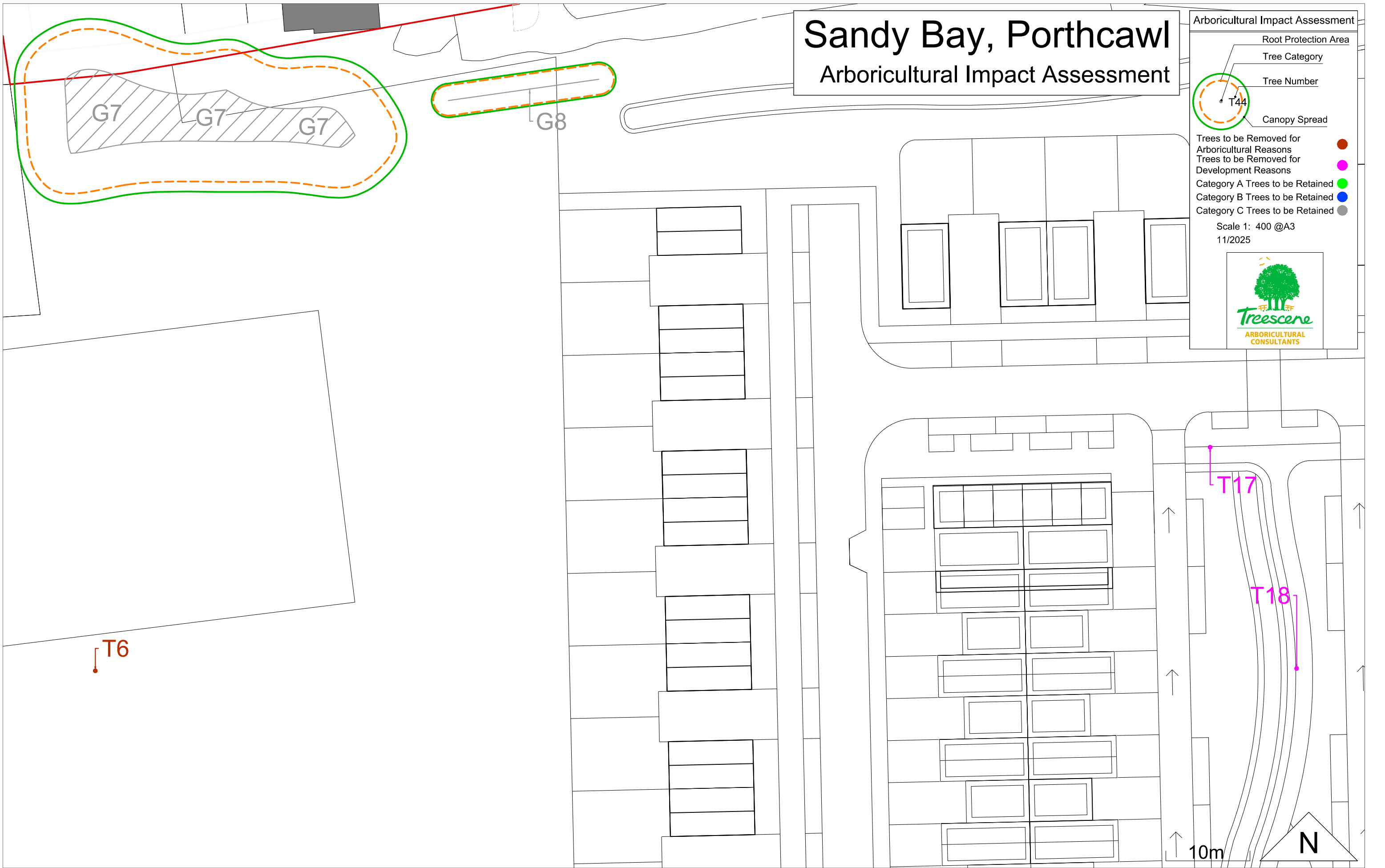

Sandy Bay, Porthcawl

Arboricultural Impact Assessment

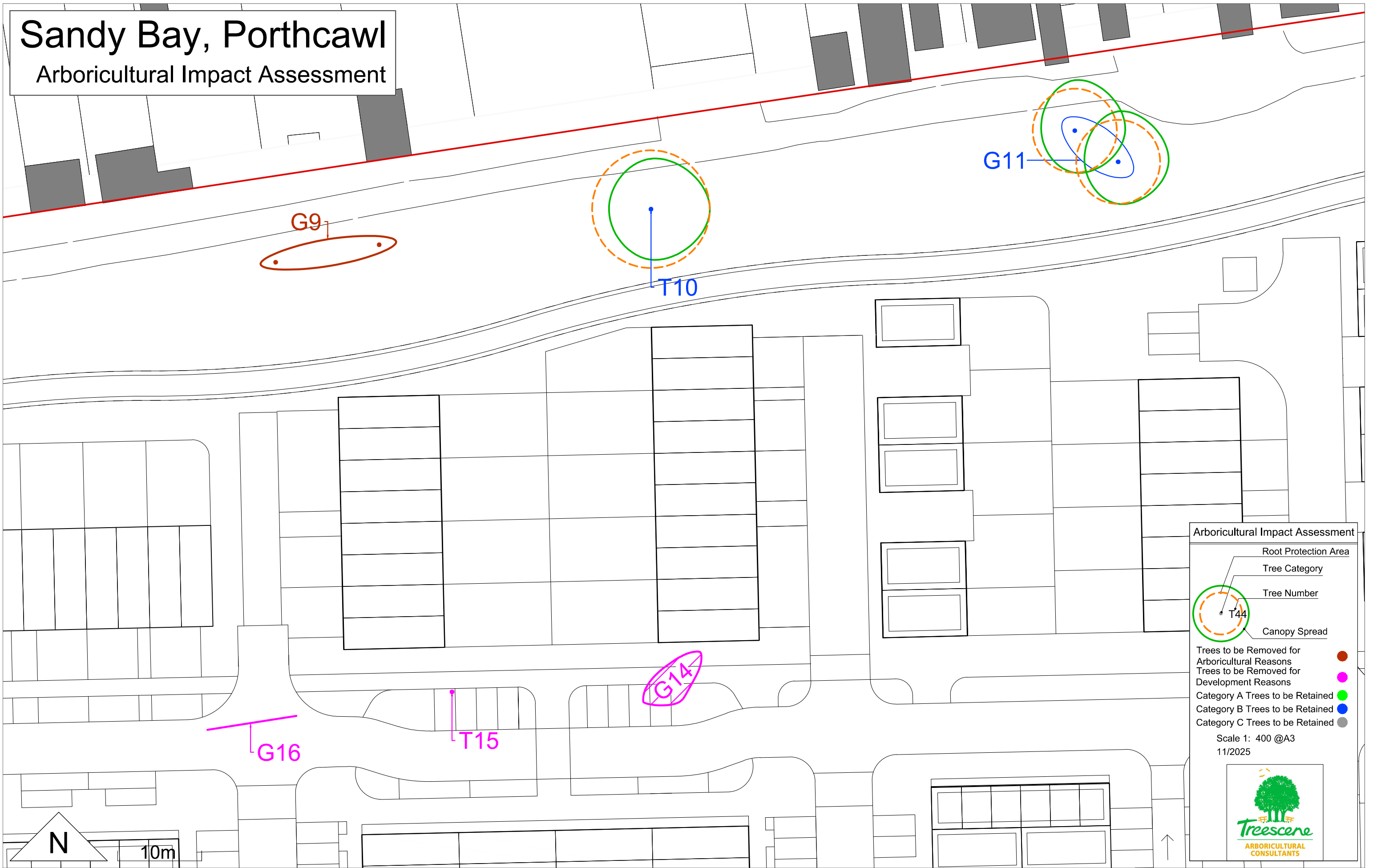

Arboricultural Impact Assessment

Root Protection Area
Tree Category
Tree Number
Canopy Spread

Trees to be Removed for Arboricultural Reasons
Trees to be Removed for Development Reasons
Category A Trees to be Retained
Category B Trees to be Retained
Category C Trees to be Retained

Scale 1: 400 @A3
11/2025

Treescene
ARBORICULTURAL CONSULTANTS

Sandy Bay, Porthcawl

Arboricultural Impact Assessment



Sandy Bay, Porthcawl

Arboricultural Impact Assessment

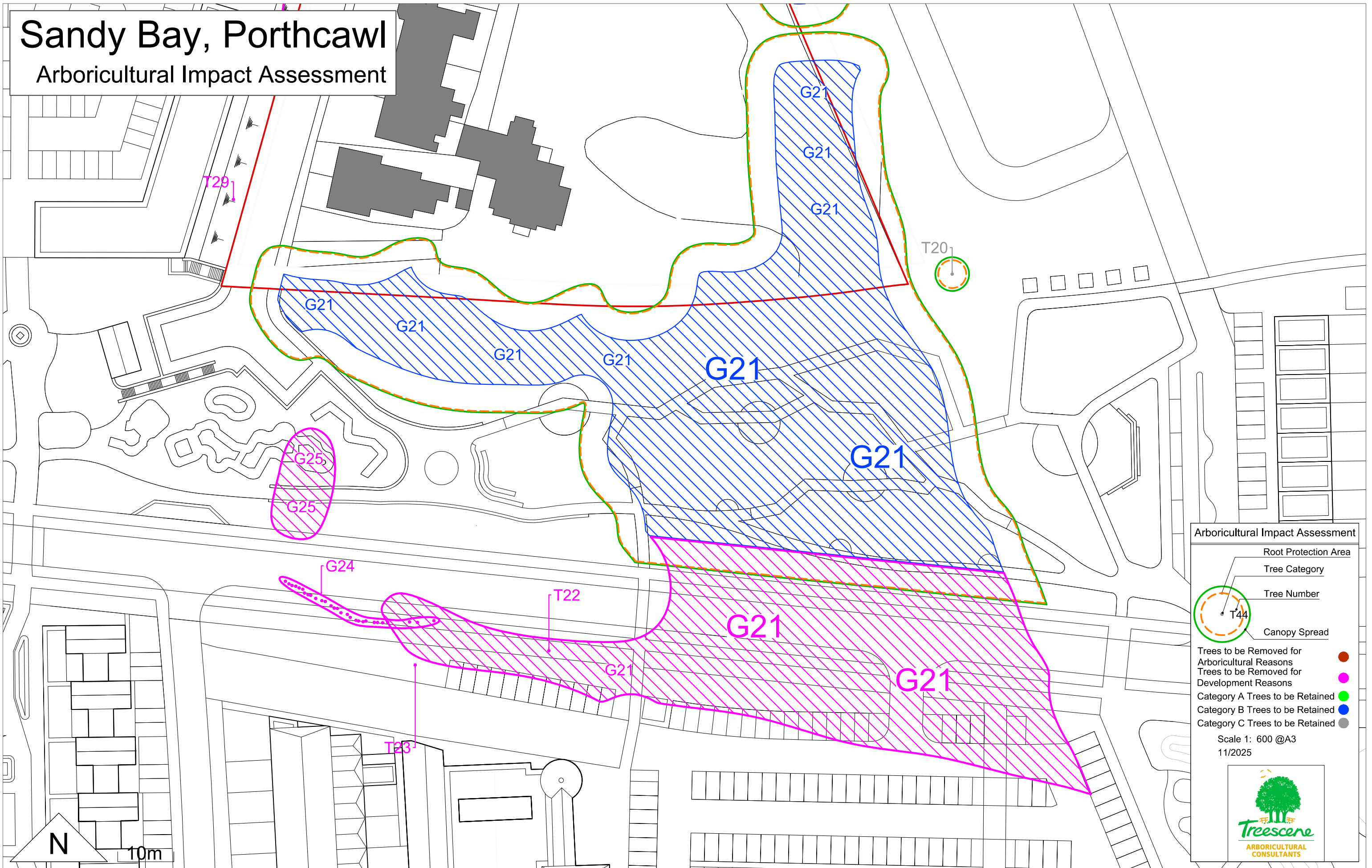

Arboricultural Impact Assessment

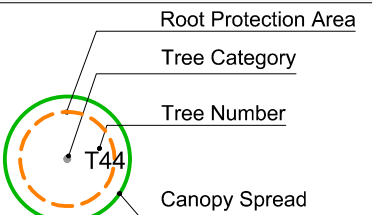

Trees to be Removed for Arboricultural Reasons
Trees to be Removed for Development Reasons
Category A Trees to be Retained
Category B Trees to be Retained
Category C Trees to be Retained

Scale 1: 600 @A3
11/2025



Sandy Bay, Porthcawl

Arboricultural Impact Assessment

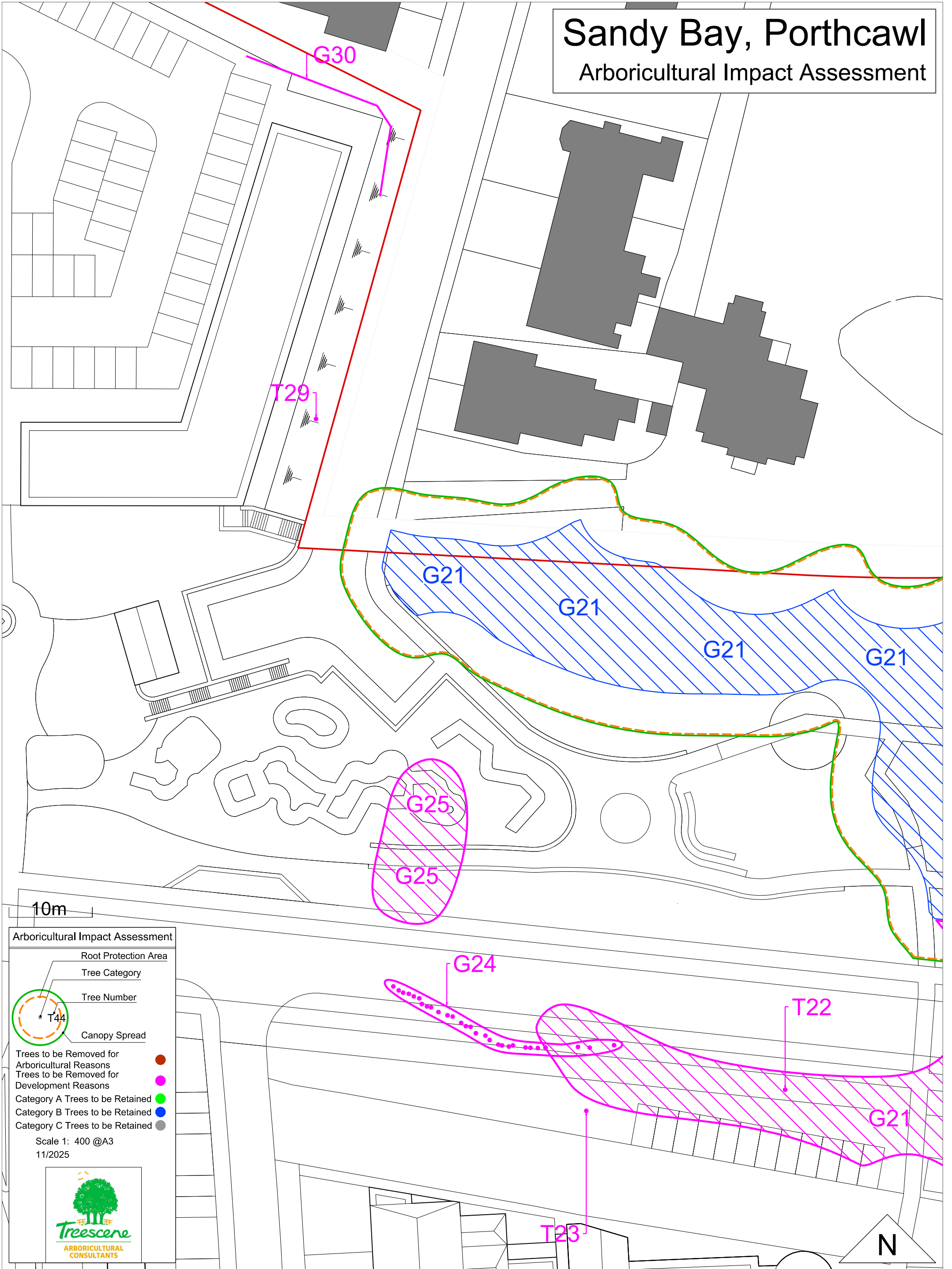

Sandy Bay, Porthcawl

Arboricultural Impact Assessment

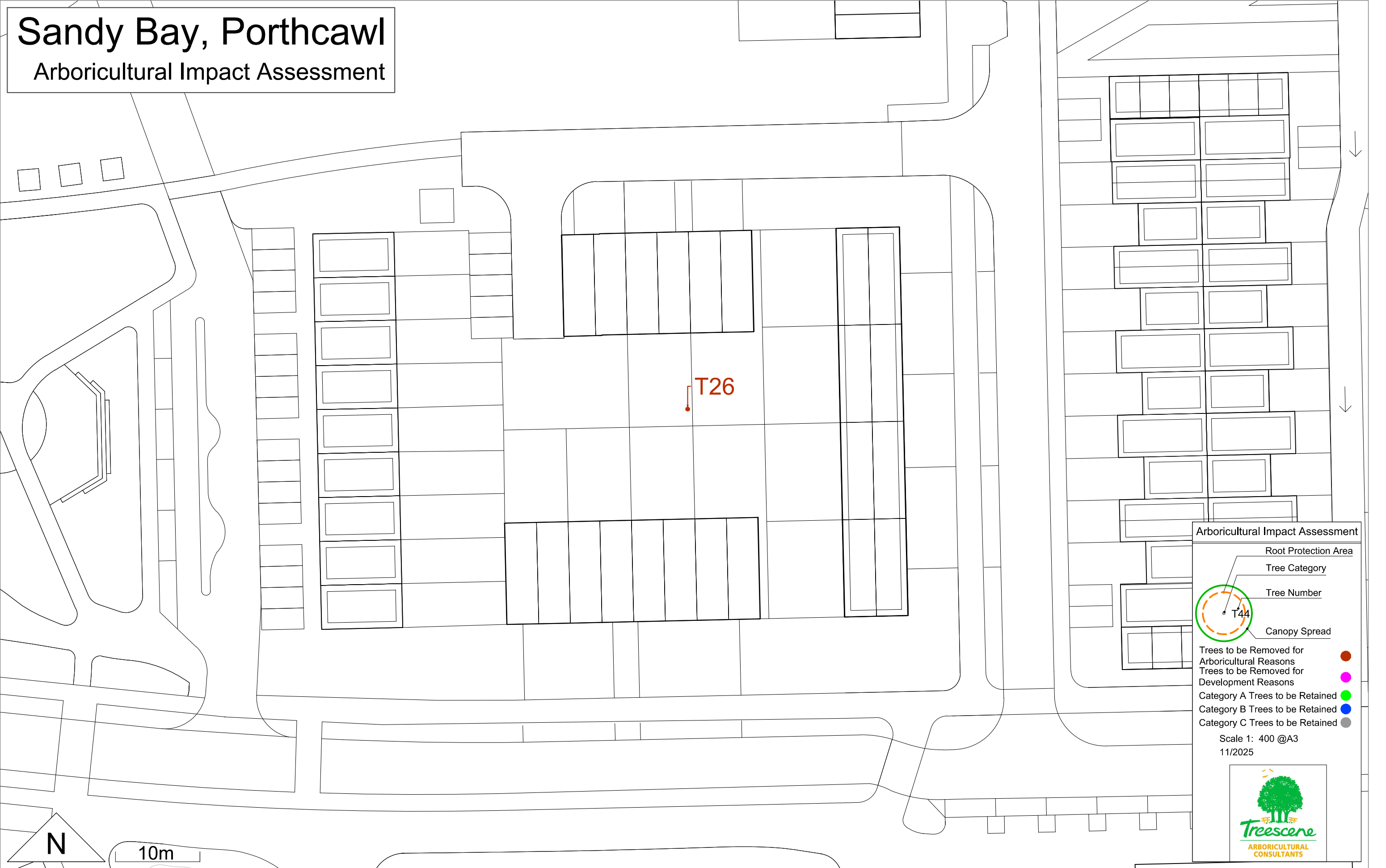

Arboricultural Impact Assessment

- Root Protection Area
- Tree Category
- Tree Number
- Canopy Spread

- Trees to be Removed for Arboricultural Reasons
- Trees to be Removed for Development Reasons
- Category A Trees to be Retained
- Category B Trees to be Retained
- Category C Trees to be Retained

Scale 1: 400 @A3
11/2025



Arboricultural Impact Assessment

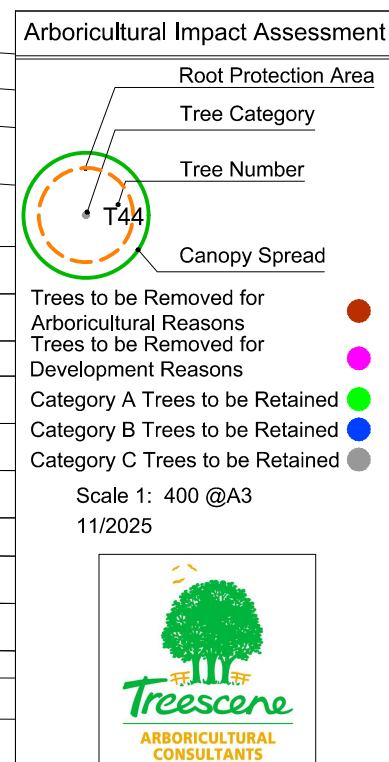

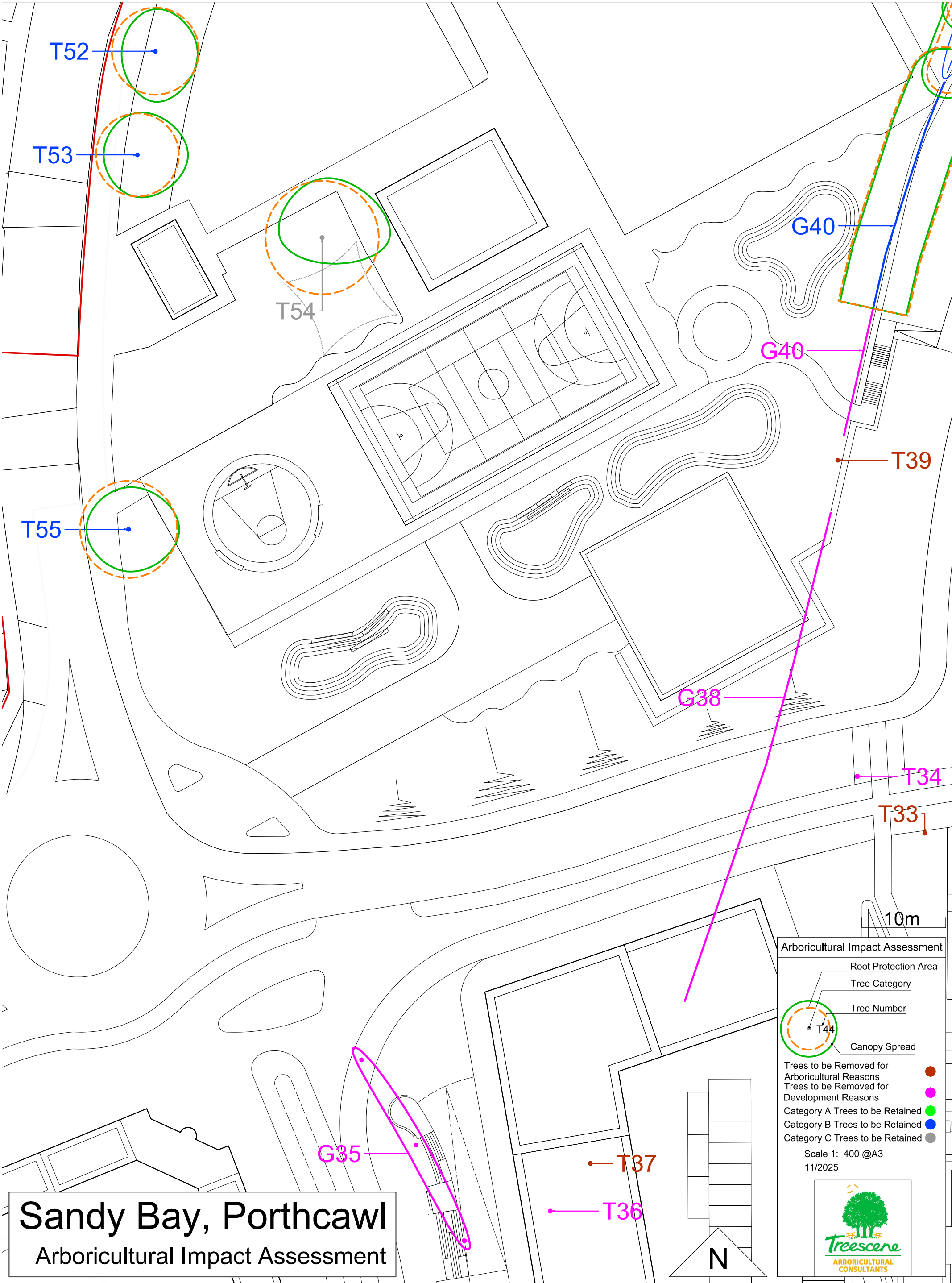

Sandy Bay, Porthcawl

Arboricultural Impact Assessment

Arboricultural Impact Assessment

Root Protection Area
Tree Category
Tree Number
Canopy Spread

Trees to be Removed for Arboricultural Reasons
Trees to be Removed for Development Reasons
Category A Trees to be Retained
Category B Trees to be Retained
Category C Trees to be Retained

Scale 1: 400 @A3
11/2025



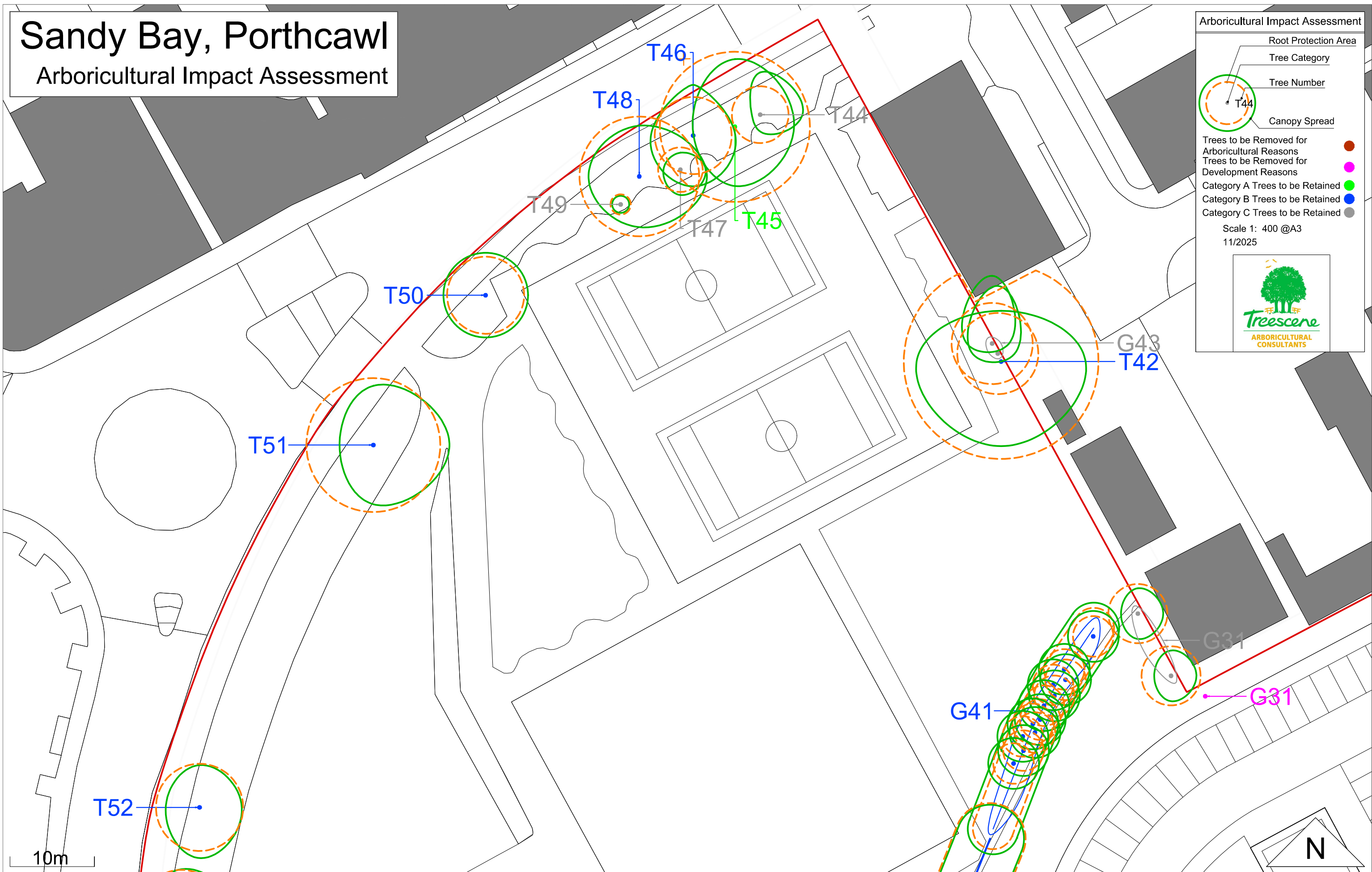

Sandy Bay, Porthcawl

Arboricultural Impact Assessment

Arboricultural Impact Assessment

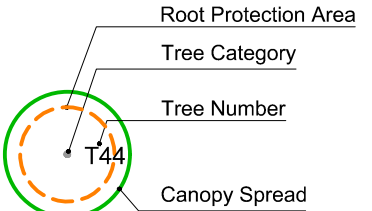

- Trees to be Removed for Arboricultural Reasons
- Trees to be Removed for Development Reasons
- Category A Trees to be Retained
- Category B Trees to be Retained
- Category C Trees to be Retained

Scale 1: 400 @A3
11/2025

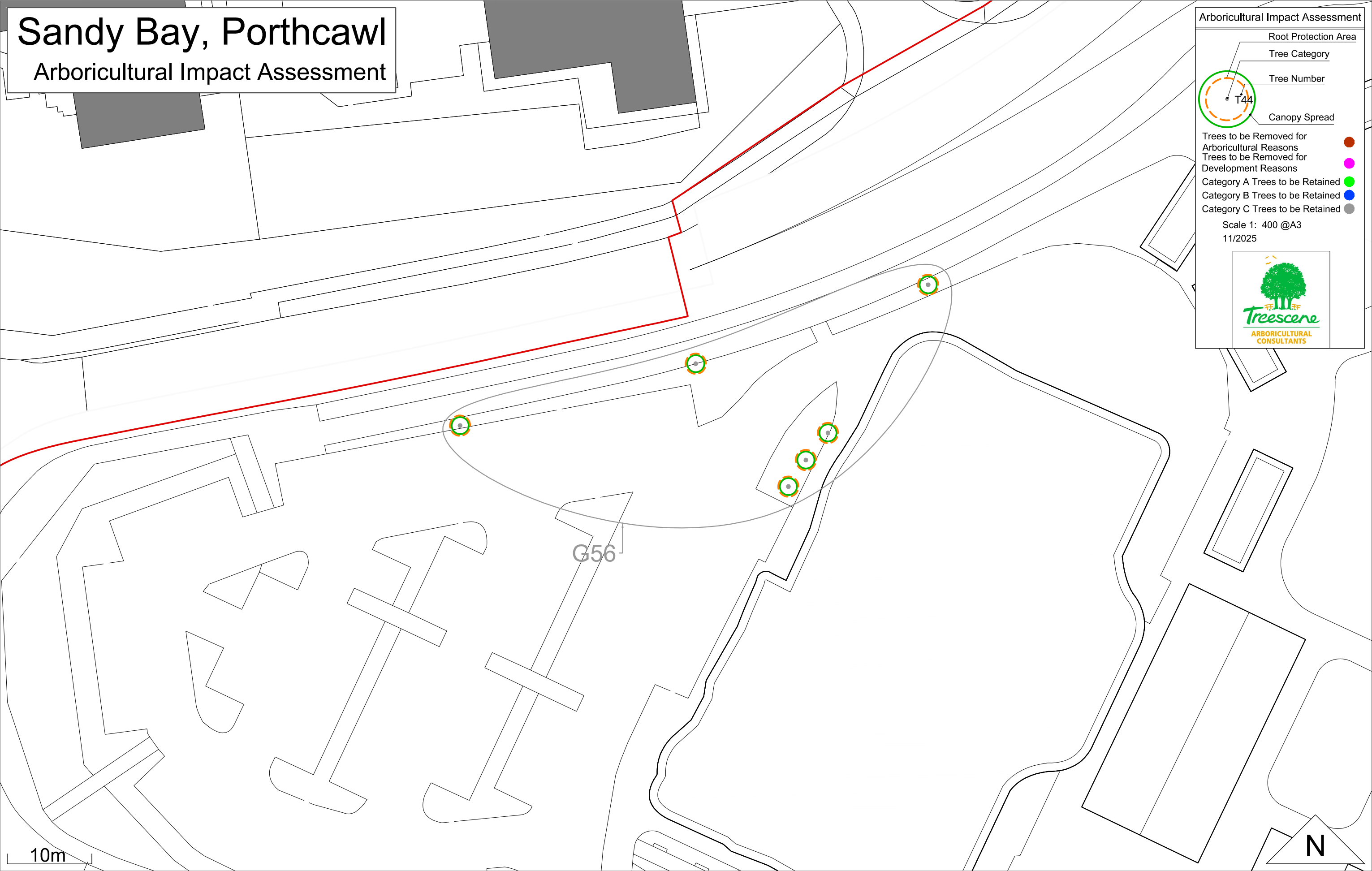

Sandy Bay, Porthcawl

Arboricultural Impact Assessment

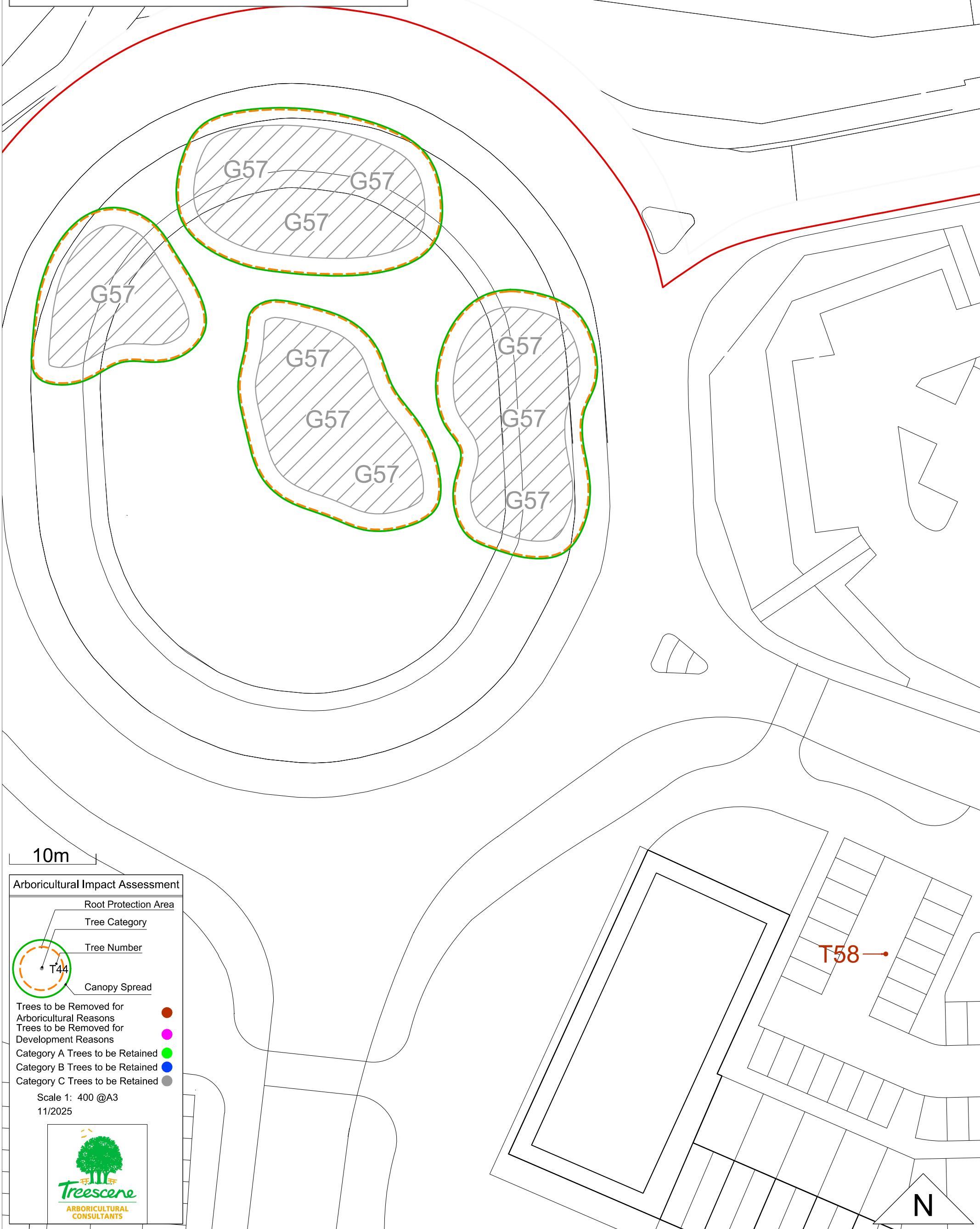

Sandy Bay, Porthcawl

Arboricultural Impact Assessment

